

PARLEC
Measurably Better

AMERICAN MADE
SHRINK FIT MACHINES & TOOL HOLDERS



8 FREE TOOL HOLDERS*

WITH THE PURCHASE OF A
ShrinkPRO
SHRINKFIT MACHINE

Changes tool in 2 - 6 seconds • Automatic cooling using shop air
Works great with carbide and high-speed steel tools

SALE: \$11,900

LIST PRICE: \$13,545

**WITH THE MACHINE & TOOL HOLDERS THAT'S
OVER \$4,000 IN SAVINGS!**

** Choose from CAT and HSK tool holders
listed on the pages below*

Expires 5/31/2024

ShrinkPRO

**2 YEAR
WARRANTY**



ShrinkFit Holders

2 Extreme Precision Shrinkfit Tools

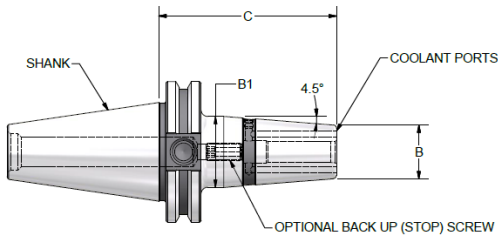

Style 1

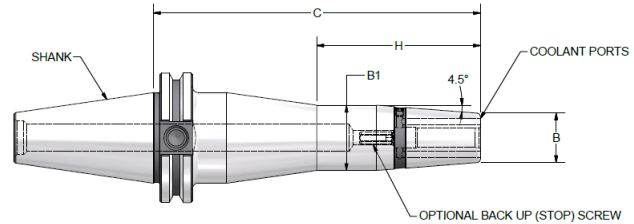

Style 2

CAT 40

SIZE	ITEM NUMBER	C	B	B1	H	THREAD	Style
1/8"	C40A-01SF315-9	3.15"	.39"	.62"	3.15"	-	3*
3/16"	C40A-18SF315-9	3.15"		.72"		-	3*
1/4"	C40A-25SF315-9C	3.15"	.83"	1.06"	3.15"	M5X.8	1
	C40A-25SF512-9C	5.12"					1
	C40A-25SF630-9C	6.30"					2
5/16"	C40A-31SF315-9C	3.15"	.94"	1.26"	3.15"	M6X1	1
3/8"	C40A-38SF315-9C	3.15"				M8X1	1
	C40A-38SF512-9C	5.12"					1
	C40A-38SF630-9C	6.30"	2				
1/2"	C40A-50SF315-9C	3.15"	1.06"	1.34"	3.15"	M10X1	1
	C40A-50SF512-9C	5.12"					1
	C40A-50SF630-9C	6.30"					2
5/8"	C40A-62SF315-9C	3.15"	1.30"	1.65"	3.15"	M12X1	1
	C40A-62SF512-9C	5.12"					1
	C40A-62SF630-9C	6.30"					2
3/4"	C40A-75SF315-9C	3.15"	1.73"	2.09"	3.15"	M16X1	1
	C40A-75SF512-9C	5.12"					1
	C40A-75SF630-9C	6.30"					2
1"	C40A-10SF394-9C	3.94"	1.73"	2.09"	3.15"	M16X1	1
	C40A-10SF512-9C	5.12"					1
	C40A-10SF630-9C	6.30"					2
1 1/4"	C40A-12SF394-9C	3.94"					1

*Style 3:
No Coolant Ports

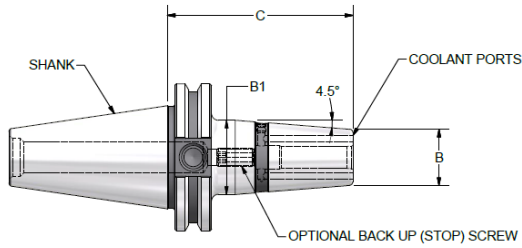

Style 1

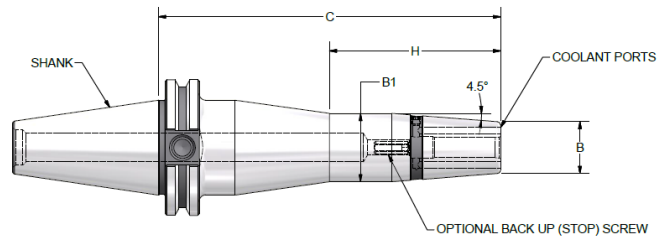

Style 2

CAT 50

SIZE	ITEM NUMBER	C	B	B1	H	THREAD	Style
1/4"	C50A-25SF315-9C	3.15"	.83"	1.06"	3.15"	M5X.8	1
	C50A-25SF512-9C	5.12"					1
	C50A-25SF630-9C	6.30"					2
5/16"	C50A-31SF315-9C	3.15"	.94"	1.26"	3.15"	M6X1	1
	C50A-31SF512-9C	5.12"					1
	C50A-31SF630-9C	6.30"					2
3/8"	C50A-38SF315-9C	3.15"	.94"	1.26"	3.15"	M8X1	1
	C50A-38SF512-9C	5.12"					1
	C50A-38SF630-9C	6.30"					2
1/2"	C50A-50SF315-9C	3.15"	.94"	1.26"	3.15"	M10X1	1
	C50A-50SF512-9C	5.12"					1
	C50A-50SF630-9C	6.30"					2
5/8"	C50A-62SF315-9C	3.15"	1.06"	1.34"	3.15"	M12X1	1
	C50A-62SF512-9C	5.12"					1
	C50A-62SF630-9C	6.30"					2
3/4"	C50A-75SF315-9C	3.15"	1.30"	1.65"	3.15"	M16X1	1
	C50A-75SF512-9C	5.12"					1
	C50A-75SF630-9C	6.30"					2
1"	C50A-10SF394-9C	3.94"	1.73"	2.09"	3.15"	M16X1	1
	C50A-10SF512-9C	5.12"					1
	C50A-10SF630-9C	6.30"					2
1 1/4"	C50A-12SF394-9C	3.94"	1.73"	2.09"	3.15"	M16X1	1
	C50A-12SF512-9C	5.12"					1
	C50A-12SF630-9C	6.30"					2

ShrinkFit Holders

4 Extreme Precision Shrinkfit Tools

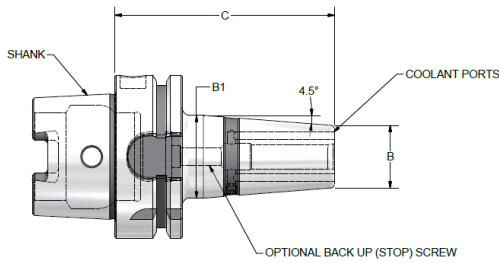

Style 1

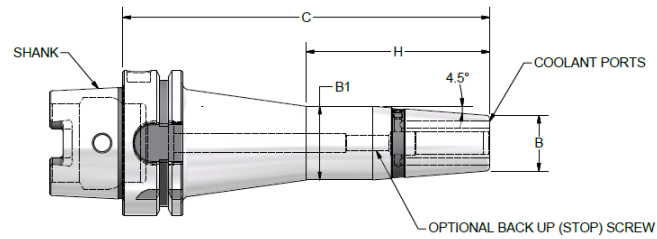

Style 2

HSK 63A - INCH

SIZE	ITEM NUMBER	C	B	B1	H	THREAD	Style
1/8"	H63A-01SF315-9	3.15"	.39"	.62"	3.15"	-	3*
3/16"	H63A-18SF315-9	3.15"		.72"		-	3*
1/4"	H63A-25SF315-9C	3.15"	.83"	1.06"	3.15"	M5X.8	1
	H63A-25SF512-9C	5.12"					1
	H63A-25SF630-9C	6.30"					2
5/16"	H63A-31SF315-9C	3.15"	.94"	1.26"	3.15"	M6X1	1
	H63A-31SF512-9C	5.12"					1
	H63A-31SF630-9C	6.30"					1
3/8"	H63A-38SF335-9C	3.35"	1.06"	1.34"	3.15"	M8X1	1
	H63A-38SF512-9C	5.12"					1
	H63A-38SF630-9C	6.30"					2
1/2"	H63A-50SF354-9C	3.54"	1.30"	1.65"	3.15"	M10X1	1
	H63A-50SF512-9C	5.12"					1
	H63A-50SF630-9C	6.30"					2
5/8"	H63A-62SF374-9C	3.74"	1.73"	2.09"	3.15"	M12X1	1
	H63A-62SF512-9C	5.12"					1
	H63A-62SF630-9C	6.30"					2
3/4"	H63A-75SF394-9C	3.94"	1.30"	1.65"	3.15"	M16X1	1
	H63A-75SF512-9C	5.12"					1
	H63A-75SF630-9C	6.30"					2
1"	H63A-10SF453-9C	4.53"	1.73"	2.09"	3.15"	M16X1	1
	H63A-10SF630-9C	5.12"					1
1 1/4"	H63A-12SF472-9C	4.72"	1.73"	2.09"	3.15"	M16X1	1
	H63A-12SF630-9C	6.30"					1

*Style 3:
No Coolant Ports

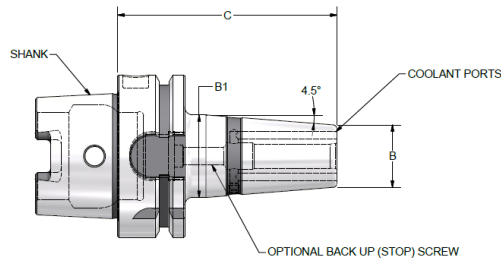

Style 1

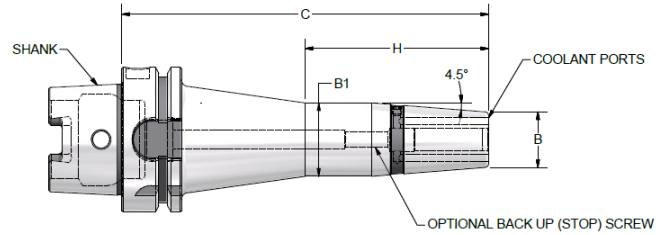

Style 2

HSK 63A - METRIC

SIZE	ITEM NUMBER	C	B	B1	H	THREAD	Style				
4 MM	H63A-M04SF80-9	3.15"	.39"	-		-	3*				
6 MM	H63A-M06SF80-9C	3.15"	.83"	1.06"	3.15"	M5X.8	1				
	H63A-M06SF130-9C	5.12"					1				
	H63A-M06SF160-9C	6.30"					2				
8 MM	H63A-M08SF80-9C	3.15"				M6X1	1				
	H63A-M08SF130-9C	5.12"					1				
	H63A-M08SF160-9C	6.30"					2				
10 MM	H63A-M10SF85-9C	3.35"	.94"	1.26"	3.15"	M8X1	1				
	H63A-M10SF130-9C	5.12"					1				
	H63A-M10SF160-9C	6.30"					2				
12 MM	H63A-M12SF90-9C	3.54"				M10X1	1				
	H63A-M12SF130-9C	5.12"					1				
	H63A-M12SF160-9C	6.30"					2				
16 MM	H63A-M16SF95-9C	3.74"	1.06"	1.34"	3.15"	M12X1	1				
	H63A-M16SF130-9C	5.12"					1				
	H63A-M16SF160-9C	6.30"					2				
20 MM	H63A-M20SF100-9C	3.94"				1.30"	1.65"	3.15"	M16X1	1	
	H63A-M20SF130-9C	5.12"								1	
	H63A-M20SF160-9C	6.30"								2	
25 MM	H63A-M25SF115-9C	4.53"	1.73"	2.09"	3.15"	M16X1	1				
	H63A-M25SF130-9C	5.12"					1				
32 MM	H63A-M32SF120-9C	4.72"					1.73"			2.09"	3.15"
	H63A-M32SF160-9C	6.30"						1			

*Style 3:
No Coolant Ports