



SLIMFIT EXTENDED REACH COLLET CHUCKS

EXTREME PRECISION, SLIM DESIGN AND EXTENDED REACH.

SlimFIT is the best collet-based system for cutting tool shanks from 3/32" up to 1/4" when cutting at extended lengths or when clearance is required. SlimFIT collets are longer and more powerful than ER collets and provide better accuracy and performance for small diameter cutting tools.



FEATURES

- .550" nose diameters
- Balanced to a minimum of 25,000 RPM at G2.5
- "On-Size" collets

ADVANTAGES OF SLIMFIT TOOL DESIGN

The drawbar tightening system reduces nose diameter. Powerful 4° taper collets improve performance when holding tool shanks from 3/32" to 1/4" (3mm-6mm). Perform fast tool changes using a T-wrench.

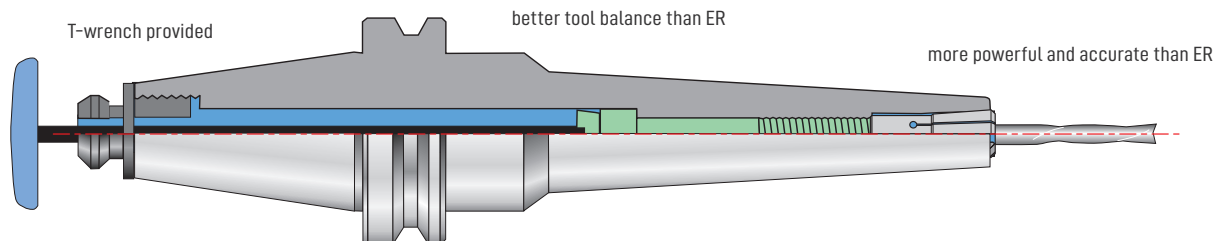

**YOU LOSE 10% OF TOOL LIFE FOR EVERY .0001" OF T.I.R.
SLIMFIT CHUCKS OFFER EXCELLENT ACCURACY AT EXTENDED LENGTHS.**

CAT SLIMFIT COLLET CHUCKS



FEATURES

- .550" nose diameters
- Balanced to a minimum of 25,000 RPM at G2.5
- "On-Size" collets

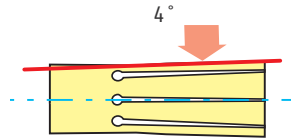

Techniks Certified for accuracy and balance. Each holder comes with a complete lab report. Taper ground to AT3 tolerance or better.

SlimFIT SBL6 holders feature 4° collets and a powerful drawbar tightening system that holds small diameter tools tighter and more accurately than ER systems. For tool shanks 3/32" up to 1/4" (3mm-6mm).

Tool changes do not require tightening fixtures or torque wrenches and can be performed using the supplied T-wrench.

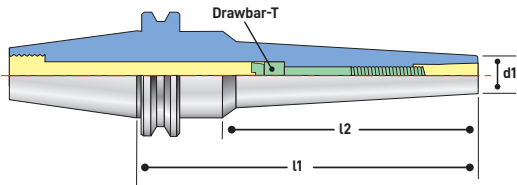

CAT SLIMFIT ER COLLET CHUCKS

Part No.	Description	l1	l2	d1	Drawbar-T
23654	CAT40 x SBL6 - 3" SlimFIT	3"	1.625"	.550"	SYIC-SBL-M6C-60
23656	CAT40 x SBL6 - 4" SlimFIT	4"	2.625"	.550"	SYIC-SBL-M6C-35
23658	CAT40 x SBL6 - 6" SlimFIT	6"	4.625"	.550"	SYIC-SBL-M6CT-78
23659	CAT40 x SBL6 - 8" SlimFIT	8"	6.622"	.550"	SYIC-SBL-M6CT-130
23672	CAT50 x SBL6-3.5" SlimFIT	3.5"	2.12"	.550"	SYIC-SBL-M6C-65
23676	CAT50 x SBL6-6" SlimFIT	6"	4.622"	.550"	SYIC-SBL-M6CT-78

SLIMFIT ACCESSORIES

Part No.	Description
T20SOTK1A81F	100mm T-Handle
T20L3TKIA81F	200mm slim shaft fits coolant retention knobs

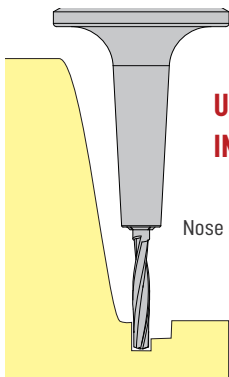

USE SLIMFIT HOLDERS FOR HIGH-PRECISION MACHINING IN TIGHT AREAS AND AT EXTENDED LENGTHS.

BT SLIMFIT COLLET CHUCKS



FEATURES

- .550" nose diameters
- Balanced to a minimum of 25,000 RPM at G2.5
- "On-Size" collets

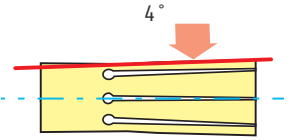

 Techniks Certified for accuracy and balance. Each holder comes with a complete lab report. Taper ground to AT3 tolerance or better.

SlimFIT SBL6 holders feature 4° collets and a powerful drawbar tightening system that holds small diameter tools tighter and more accurately than ER systems. For tool shanks 3/32" up to 1/4" (3mm-6mm).

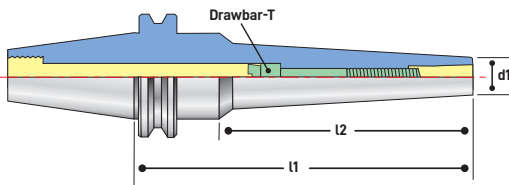

Tool changes do not require tightening fixtures or torque wrenches and can be performed using the supplied T-wrench.

BT SLIMFIT ER COLLET CHUCKS

Part No.	Description	l1	l2	d1	Drawbar-T
18854	BT30 x SBL6-70	70mm	48mm	.550"	SYIC-SBL-M6C-45
18856	BT30 x SBL6-100	100mm	78mm	.550"	SYIC-SBL-M6C-65
18866	BT40 x SBL6-70	70mm	43mm	.550"	SYIC-SBL-M6C-45
18868	BT40 x SBL6-100	100mm	73mm	.550"	SYIC-SBL-M6CT-78
18868-150	BT40 x SBL6-150	150mm	123mm	.550"	SYIC-SBL-M6C-65
18869	BT40 x SBL6-200	200mm	173mm	.550"	SYIC-SBL-M6CT-130

SLIMFIT ACCESSORIES

Part No.	Description
T20SOTK1A81F	100mm T-Handle
T20L3TKIA81F	200mm slim shaft fits coolant retention knobs

WHY SLIMFIT OUT-PERFORMS ER COLLET SYSTEMS

SlimFIT collets are longer overall than ER collets and feature a 4° taper, delivering better engagement between collet and tool shank, resulting in better accuracy and balance than ER systems.

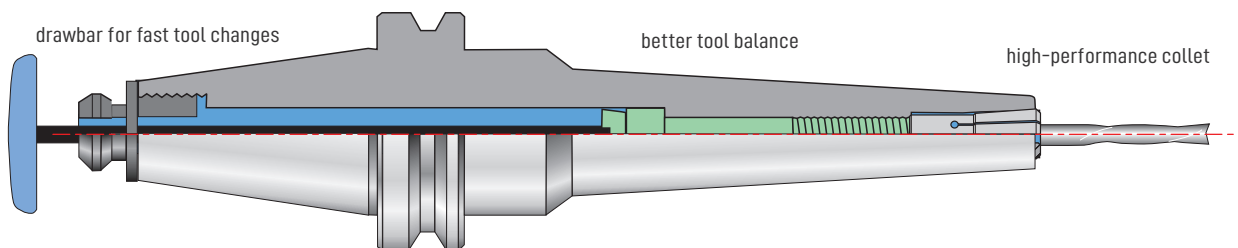

HSK63A SLIMFIT COLLET CHUCKS



FEATURES

- .550" nose diameters
- Balanced to a minimum of 25,000 RPM at G2.5
- "On-Size" collets

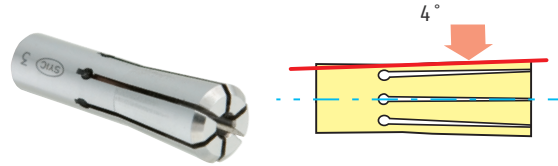

Techniks Certified for accuracy and balance. Each holder comes with a complete lab report.

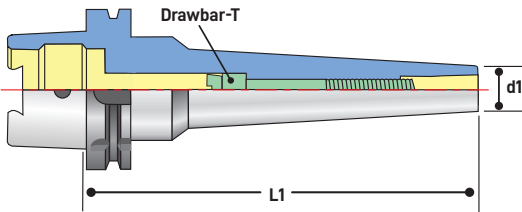

SlimFIT SBL6 holders feature 4° collets and a powerful drawbar tightening system that holds small diameter tools tighter and more accurately than ER systems. For tool shanks 3/32" up to 1/4" (3mm-6mm).

Tool changes do not require tightening fixtures or torque wrenches and can be performed using the supplied T-wrench.

HSK63A SLIMFIT ER COLLET CHUCKS

Part No.	Description	l1	l2	d1	Drawbar-T
35470	HSK63A x SBL6-80 SlimFIT	80mm	54mm	.550"	SYIC-SBL-M6C-15
35472	HSK63A x SBL6-120 SlimFIT	120mm	94mm	.550"	SYIC-SBL-M6CT-50

SLIMFIT ACCESSORIES

Part No.	Description
92004	HSK63A Coolant Pipe
93.11.026.004	Coolant Pipe Wrench
T20SOTK1A81F	100mm T-Handle
T20L3TKIA81F	200mm slim shaft fits coolant retention knobs

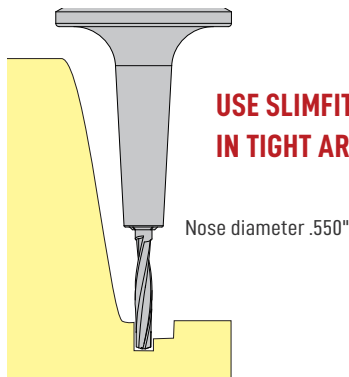

USE SLIMFIT HOLDERS FOR HIGH-PRECISION MACHINING IN TIGHT AREAS AND AT EXTENDED LENGTHS.

Nose diameter .550"

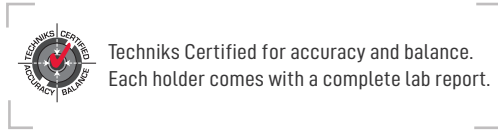

FEATURES

- Only .480" nose diameter
- Use with any 1/2" or 5/8" toolholder, including end mill holders.
- 4° angle drawbar collet for greater holding power and accuracy

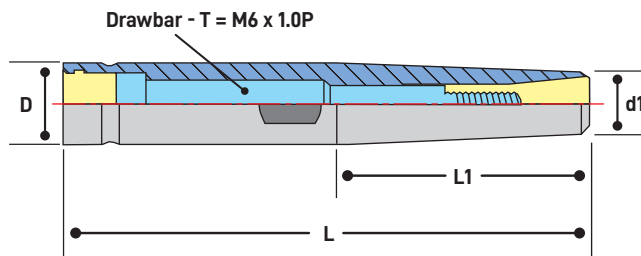

SLIMFIT EXTENSIONS

Part No.	Description	D	L	l1	d1
06032-3	1/2" x OLP6-3" extension	.50"	3"	1.89"	.48
06032	1/2" x OLP6-5" extension	.50"	5"	1.89"	.48
06034	1/2" x OLP6-6" extension	.50"	6"	1.89"	.48
06038	5/8" x OLP6-5" extension	.625"	5"	1.89"	.48
06040	5/8" x OLP6-6" extension	.625"	6"	1.89"	.48
06042	5/8" x OLP6-8" extension	.625"	8"	1.89"	.48

Note: Extensions Fit 1/2" or 5/8" Toolholders

EXTENSIONS CONVERT ANY 1/2" OR 5/8" TOOLHOLDER INTO A SLIMFIT TOOL!



Extensions feature a nose clearance of .480", providing access to areas unreachable by standard length tool holders.

**YOU LOSE 10% OF TOOL LIFE FOR EVERY .0001" OF T.I.R.
SLIMFIT CHUCKS OFFER EXCELLENT ACCURACY AT EXTENDED LENGTHS.**



SLIMFIT COLLETS



FEATURES

- "On-Size" collets
- Precision ground and polished
- Each collet individually inspected for quality

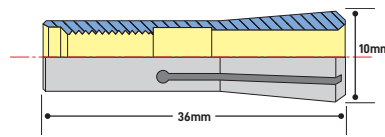

NOTE: TIGHTEN TO 9 FT/LBS

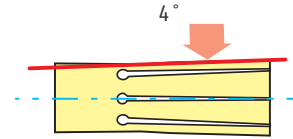

SLIMFIT COLLET SET

Part No.	Description
18851-12IMS	SlimFIT 12 piece set

Convenient collet set provides the collets you need and the wooden tray prevents damage to collets.

Set includes 12 collets:

INCH: 7/64", 1/8", 9/64", 11/64"

3/16", 13/64", 15/64", 1/4"

METRIC: 3mm, 4mm, 5mm, 6mm

SLIMFIT COLLETS INCH

Part No.	Description
18851-3/32	SlimFIT 6 - 3/32" collet
18851-7/64	SlimFIT 6 - 7/64" collet
18851-1/8	SlimFIT 6 - 1/8" collet
18851-9/64	SlimFIT 6 - 9/64" collet
18851-5/32	SlimFIT 6 - 5/32" collet
18851-11/64	SlimFIT 6 - 11/64" collet
18851-3/16	SlimFIT 6 - 3/16" collet
18851-13/64	SlimFIT 6 - 13/64" collet
18851-7/32	SlimFIT 6 - 7/32" collet
18851-15/64	SlimFIT 6 - 15/64" collet
18851-1/4	SlimFIT 6 - 1/4" collet

SLIMFIT COLLETS METRIC

Part No.	Description
18851-03	SlimFIT 6 - 3mm collet
18851-04	SlimFIT 6 - 4mm collet
18851-05	SlimFIT 6 - 5mm collet
18851-05.5	SlimFIT 6 - 5.5mm collet
18851-06	SlimFIT 6 - 6mm collet

WHY SLIMFIT OUT-PERFORMS ER COLLET SYSTEMS

SlimFIT collets are longer overall than ER collets and feature a 4° taper, delivering better engagement between collet and tool shank, resulting in better accuracy and balance than ER systems.

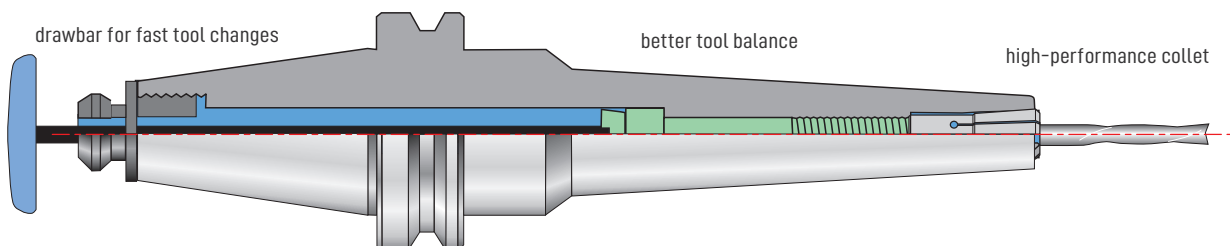

DNA (DEAD NUTS ACCURATE) COLLETS



FEATURES

- Compatible with ER collet chucks and extensions
- 0.0002" T.I.R. extends tool life
- More rigid and more accurate than ER for small diameter shanks

DNA 11 COLLETS & ACCESSORIES

Part No.	Shank Size inch/mm	Collapse Range inch/mm
05952-02	5/64" / 1.5 - 2mm	.059" - .079" / .5mm
05952-03	7/64" / 2.5 - 3mm	.098" - .118" / .5mm
05952-03.5	1/8" / 3 - 3.5mm	.118" - .138" / .5mm
05952-04	5/32" / 3.5 - 4mm	.138" - .157" / .5mm
05952-05	3/16" / 4.5 - 5mm	.177" - .197" / .5mm
05952-06	15/64" / 5.5 - 6mm	.216" - .236" / .5mm
05952-1/8	exact size collet: 1/8"	.105" - .125" / .5mm
05952-3/16	exact size collet: 3/16"	.167" - .187" / .5mm
05952-1/4	exact size collet: 1/4"	.230" - .250" / .5mm
2011.0000	DNA 11 nut M14 x .75"	
04608	DNA 11 collet wrench	
DNA11TWA	DNA 11 torque wrench adapter	

Use the table for selecting your replacement collets. DNA collets all have unique length and diameter measurements.

DNA DIMENSIONS

Collet	L	D
DNA 11	.673	.460
DNA 16	.945	.654
DNA 20	1.201	.815
DNA 32	1.571	1.301

DNA 16 COLLETS & ACCESSORIES

Part No.	Shank Size inch/mm	Range inch/mm
05954-0.3	.2 - .3mm	.007" - .011" / .10mm
05954-0.4	1/64" / .3 - .4mm	.011" - .015" / .10mm
05954-0.5	.4 - .5mm	.015" - .019" / .10mm
05954-0.6	.5 - .6mm	.019" - .023" / .10mm
05954-0.8	1/32" / .7 - .8mm	.027" - .031" / .10mm
05954-1.0	.9 - 1.0mm	.035" - .039" / .10mm
05954-1.2	3/64" / 1.1 - 1.2mm	.043" - .047" / .10mm
05954-1.25	1.0 - 1.25mm	.039" - .049" / .25mm
05954-1.5	1.25 - 1.5mm	.049" - .059" / .25mm
05954-1.75	1/16" / 1.5 - 1.75mm	.059" - .068" / .25mm
05954-02	5/64" / 1.75 - 2mm	.068" - .078" / .25mm
05954-2.25	2 - 2.25mm	.078" - .088" / .25mm
05954-2.5	3/32" / 2.25 - 2.5mm	.088" - .098" / .25mm
05954-03	2.5 - 3mm	.098" - .118" / .5mm
05954-3.5	1/8" / 3 - 3.5mm	.118" - .138" / .5mm
05954-04	5/32" / 3.5 - 4mm	.137" - .157" / .5mm
05954-4.5	4 - 4.5mm	.157" - .177" / .5mm
05954-05	3/16" / 4 - 5mm	.157" - .197" / 1.0mm
05954-06	7/32" / 5 - 6mm	.196" - .236" / 1.0mm
05954-07	1/4" / 6 - 7mm	.236" - .275" / 1.0mm
05954-08	5/16" / 7 - 8mm	.275" - .314" / 1.0mm
05954-09	11/32" / 8 - 9mm	.314" - .354" / 1.0mm
05954-10	3/8" / 9 - 10mm	.354" - .392" / 1.0mm
05954-1/8	exact size collet: 1/8"	.105" - .125" / .5mm
05954-3/16	exact size collet: 3/16"	.147" - .187" / 1.0mm
05954-1/4	exact size collet: 1/4"	.210" - .25" / 1.0mm
05954-3/8	exact size collet: 3/8"	.335 - .375" / 1.0mm

HOW IT WORKS

ER Collet: large counterbore leaves shank unsupported

DNA Collet: twice as much metal holding tool shank!

DNA collets hold small tools with greater rigidity and more accuracy (T.I.R.) for greatly improved tool life.

DNA (DEAD NUTS ACCURATE) COLLETS



DNA Sealed Nut



DNA 16 Nut

DNA NUTS FEATURE POWERCOAT FOR 75% MORE HOLDING POWER AND BEST TOOL LIFE.

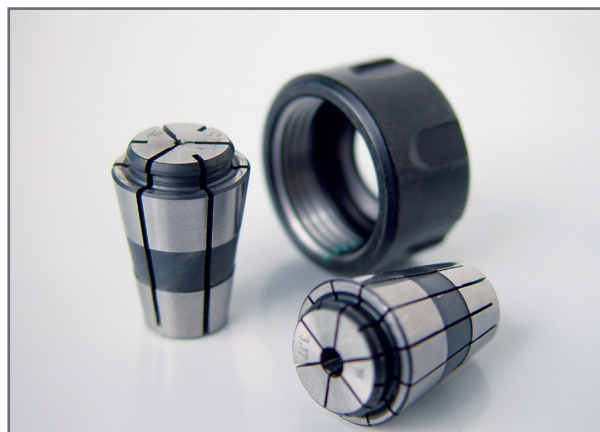

DNA 16 NUTS & ACCESSORIES

Part No.	Description
2016-2000	DNA16 Mini Nut - M19 x 1.0" x O.D. 25mm
27116	M22 x 1.5 nut, , O.D. 27mm
27116-30	3.0 - 2.5mm sealed nut, O.D. 27mm
27116-40	4.0 - 3.5mm sealed nut, O.D. 27mm
27116-45	4.5 - 4.0mm sealed nut, O.D. 27mm
27116-50	5.0 - 4.5mm sealed nut, O.D. 27mm
27116-55	5.5 - 5mm sealed nut, O.D. 27mm
27116-60	6.0 - 5.5mm sealed nut, O.D. 27mm
27116-65	6.5 - 6mm sealed nut, O.D. 27mm
DNA16W	DNA 16 collet wrench
DNA16TWA	DNA 16 torque wrench adapter
894-22	DNA 16 mini nut wrench

DNA 20 COLLETS & ACCESSORIES

Part No.	Shank Size inch/mm	Range inch/mm
05956-03	2.5 - 3mm	.098" - .118" / .5mm
05956-3.5	1/8" / 3 - 3.5mm	.118" - .138" / .5mm
05956-04	5/32" / 3.5 - 4mm	.137" - .157" / .5mm
05956-05	3/16" / 4 - 5mm	.157" - .197" / 1.0mm
05956-06	7/32" 5 - 6mm	.197" - .236" / 1.0mm
05956-1/8	exact size collet: 1/8"	.105" - .125" / .5mm
05956-3/16	exact size collet: 3/16"	.147" - .187" / 1.0mm
05956-1/4	exact size collet: 1/4"	.210" - .250" / 1.0mm
05956-3/8	exact size collet: 3/8"	.335" - .375" / 1.0mm
2020.0000	DNA 20 nut, M25 x 1.5" O.D. 32mm	
2020.0000C	DNA 20 coolant nut, uses ER20 rings	
DNA20W	DNA 20 collet wrench	
DNA20TWA	DNA 20 torque wrench adapter	

DNA 32 COLLETS & ACCESSORIES

Part No.	Shank Size inch/mm	Range inch/mm
05958-03	2.5 - 3mm	.098" - .118" / .5mm
05958-3.5	1/8" / 3 - 3.5mm	.118" - .138" / .5mm
05958-04	5/32" / 3.5 - 4mm	.137" - .157" / .5mm
05958-05	3/16" / 4 - 5mm	.157" - .197" / 1.0mm
05958-06	7/32" 5 - 6mm	.197" - .236" / 1.0mm
05958-1/8	exact size collet: 1/8"	.105" - .125" / .5mm
05958-3/16	exact size collet: 3/16"	.147" - .187" / 1.0mm
05958-1/4	exact size collet: 1/4"	.210" - .250" / 1.0mm
05958-3/8	exact size collet: 3/8"	.335" - .375" / 1.0mm
05958-1/2	exact size collet: 1/2"	.460" - .5" / 1.0mm
05958-3/4	exact size collet: 3/4"	.710" - .75" / 1.0mm
05958-13	exact size collet: 13mm	.472" - .512" / 1.0mm
05958-20	exact size collet: 20mm	.748" - .787" / 1.0mm
1132.0000	DNA 32 nut, M40 x 1.5" O.D. 47.5mm	
1132.0000C	DNA 32 coolant nut, uses ER25 rings	
DNA32W	DNA 32 collet wrench	
DNA32TWA	DNA 32 torque wrench adapter	

DNA COLLETS VS. ER COLLETS

PROJECTION COMPARISON

DNA collets provide shorter projection from the collet chuck for better rigidity and when clearance is needed.

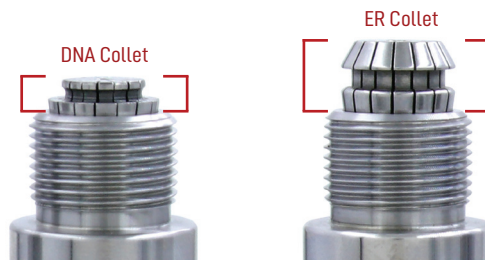

Mold-Style Milling Chucks

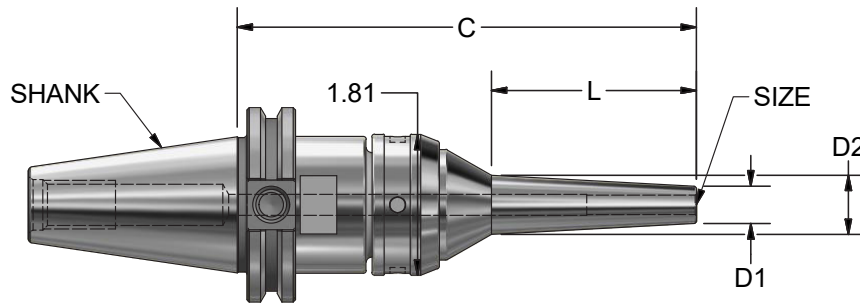

FEATURES

- Narrow nose design allows for deep, hard-to-reach machining
- Max. T.I.R. of 5 microns at 3xD enhances performance and tool-life
- Balanced to 15,000 RPM @ G2.5
- Unique Thrust-Ring clamping system produces exceptional holding power

CAT 40 Mold-Style Milling Chucks

Part #	Old Description	New Description	Bore Size	C	L	D1	D2
74304083	CV40-HPC0125M-150	CAT40 x MSMC 1/8" - 5.90"	1/8"	5.90"	2.63"	.35"	.63"
74304084	CV40-HPC0125M-200	CAT40 x MSMC 1/8" - 7.87"	1/8"	7.87"	4.01"	.35"	.70"
74304085	CV40-HPC0187M-150	CAT40 x MSMC 3/16" - 5.90"	3/16"	5.90"	2.63"	.43"	.72"
74304022	CV40-HPC0187M-200	CAT40 x MSMC 3/16" - 7.87"	3/16"	7.87"	4.01"	.43"	.86"
74304087	CV40-HPC0250M-150	CAT40 x MSMC 1/4" - 5.90"	1/4"	5.90"	2.63"	.48"	.76"
74304023	CV40-HPC0250M-200	CAT40 x MSMC 1/4" - 7.87"	1/4"	7.87"	4.01"	.48"	.91"
74304089	CV40-HPC0312M-150	CAT40 x MSMC 5/16" - 5.90"	5/16"	5.90"	2.63"	.55"	.83"
74304090	CV40-HPC0312M-200	CAT40 x MSMC 5/16" - 7.87"	5/16"	7.87"	4.01"	.55"	.97"
74304024	CV40-HPC0312M-200-T	CAT40 x MSMC 5/16" - 7.87" BST	5/16"	7.87"	4.01"	.55"	.97"
74304091	CV40-HPC0375M-150	CAT40 x MSMC 3/8" - 5.90"	3/8"	5.90"	2.63"	.61"	.89"
74304026	CV40-HPC0375M-200	CAT40 x MSMC 3/8" - 7.87"	3/8"	7.87"	4.01"	.61"	1.03"
74304027	CV40-HPC0437M-150	CAT40 x MSMC 7/16" - 5.90"	7/16"	5.90"	2.63"	.67"	.95"
74304028	CV40-HPC0437M-200	CAT40 x MSMC 7/16" - 7.87"	7/16"	7.87"	4.01"	.67"	1.09"
74304095	CV40-HPC0500M-150	CAT40 x MSMC 1/2" - 5.90"	1/2"	5.90"	2.63"	.74"	1.01"
74304096	CV40-HPC0500M-200	CAT40 x MSMC 1/2" - 7.87"	1/2"	7.87"	4.01"	.74"	1.16"
74304067	CV40-HPC03M-150	CAT40 x MSMC 3MM - 5.90"	3 mm	5.90"	2.63"	.35"	.63"
74304069	CV40-HPC04M-150	CAT40 x MSMC 4MM - 5.90"	4 mm	5.90"	2.63"	.39"	.67"
74304073	CV40-HPC06M-150	CAT40 x MSMC 6MM - 5.90"	6 mm	5.90"	2.63"	.47"	.75"
74304077	CV40-HPC08M-150	CAT40 x MSMC 8MM - 5.90"	8 mm	5.90"	2.63"	.55"	.83"
74304079	CV40-HPC10M-150	CAT40 x MSMC 10MM - 5.90"	10 mm	5.90"	2.63"	.63"	.92"
74304081	CV40-HPC12M-150	CAT40 x MSMC 12MM - 5.90"	12 mm	5.90"	2.63"	.71"	1.00"

Mold-Style Milling Chucks

CAT 50 Mold-Style Milling Chucks

Part #	Old Description	New Description	Bore Size	C	L	D1	D2
74305033	CV50-HPC0125M-150	CAT50 x MSMC 1/8" - 5.90"	1/8"	5.90"	2.63"	.35"	.63"
74305034	CV50-HPC0187M-150	CAT50 x MSMC 3/16" - 5.90"	3/16"	5.90"	2.63"	.43"	.72"
74305035	CV50-HPC0187M-200	CAT50 x MSMC 3/16" - 7.87"	1/6"	7.87"	4.01"	.43"	.86"
74305159	CV50-HPC0250M-150	CAT50 x MSMC 1/4" - 5.90"	1/4"	5.90"	2.63"	.48"	.76"
74305036	CV50-HPC0312M-150	CAT50 x MSMC 5/16" - 5.90"	3/16"	5.90"	2.63"	.55"	.83"
74305037	CV50-HPC0375M-200	CAT50 x MSMC 3/8" - 7.87"	3/8"	7.87"	4.01"	.61"	1.03"
74305136	CV50-HPC0500M-200-T	CAT50 x MSMC 1/2" - 7.87"	1/2"	7.87"	4.01"	.74"	1.01"
74305038	CV50-HPC06M-150	CAT50 x MSMC 6MM - 5.90"	6 mm	5.90"	2.63"	.47"	.75"
74305039	CV50-HPC06M-200	CAT50 x MSMC 6MM - 7.87"	6 mm	7.87"	4.01"	.47"	.89"

BT 40 Mold-Style Milling Chucks

Part #	Old Description	New Description	Bore Size	C	L	D1	D2
74204135	BT40-HPC0125M-135	BT40 x MSMC 1/8" - 5.31"	1/8"	5.31"	2.63"	.35"	.63"
74204010	BT40-HPC0125M-185	BT40 x MSMC 1/8" - 7.28"	1/8"	7.28"	4.01"	.35"	.70"
74204011	BT40-HPC0187M-185	BT40 x MSMC 3/16" - 7.28"	3/16"	7.28"	4.01"	.43"	.72"
74204012	BT40-HPC0250M-185	BT40 x MSMC 1/4" - 7.28"	1/4"	7.28"	4.01"	.48"	.91"
74204013	BT40-HPC0312M-135 (T)	BT40 x MSMC 5/16" - 5.31"	5/16"	5.31"	2.63"	.55"	.83"
74204014	BT40-HPC0312M-185 (T)	BT40 x MSMC 5/16" - 7.28"	5/16"	7.28"	4.01"	.55"	.97"
74204015	BT40-HPC0375M-185	BT40 x MSMC 3/8" - 7.28"	3/8"	7.28"	4.01"	.61"	1.03"
74204016	BT40-HPC0500M-185	BT40 x MSMC 1/2" - 7.28"	1/2"	7.28"	4.01"	.74"	1.01"

HSK 63A Mold-Style Milling Chucks

Part #	Old Description	New Description	Bore Size	C	L	D1	D2
74406114	HSKA63-HPC0125M-150	HSK63A x MSMC 1/8" - 5.90"	1/8"	5.90"	2.63"	.35"	.63"
74406113	HSKA63-HPC0187M-150	HSK63A x MSMC 3/16" - 5.90"	3/16"	5.90"	2.63"	.43"	.72"
74406047	HSKA63-HPC0187M-200	HSK63A x MSMC 3/16" - 7.87"	3/16"	7.87"	4.01"	.43"	.86"
74406112	HSKA63-HPC0250M-150	HSK63A x MSMC 1/4" - 5.90"	1/4"	5.90"	2.63"	.48"	.76"
74406101	HSKA63-HPC0250M-200	HSK63A x MSMC 1/4" - 7.87"	1/4"	7.87"	4.01"	.48"	.91"
74406111	HSKA63-HPC0375M-150	HSK63A x MSMC 3/8" - 5.90"	3/8"	5.90"	2.63"	.61"	.89"
74406109	HSKA63-HPC0500M-150	HSK63A x MSMC 1/2" - 5.90"	1/2"	5.90"	2.63"	.74"	1.01"
74406048	HSKA63-HPC0500M-200-T	HSK63A x MSMC 1/2" - 7.87"	1/2"	7.87"	4.01"	.74"	1.01"

HSK 100A Mold-Style Milling Chucks

Part #	Old Description	New Description	Bore Size	C	L	D1	D2
74401137	HSKA100-HPC0125M-155	HSK100A x MSMC 1/8" - 6.10"	1/8"	6.10"	2.63"	.35"	.63"
74401040	HSKA100-HPC0250M-155	HSK100A x MSMC 1/4" - 6.10"	1/4"	6.10"	2.63"	.48"	.76"
74401041	HSKA100-HPC0250M-205	HSK100A x MSMC 1/4" - 8.07"	1/4"	8.07"	4.01"	.48"	.91"
74401160	HSKA100-HPC0375M-155	HSK100A x MSMC 3/8" - 6.10"	3/8"	6.10"	2.63"	.61"	.89"
74401042	HSKA100-HPC0500M-155	HSK100A x MSMC 1/2" - 6.10"	1/2"	6.10"	2.63"	.74"	1.01"

Mold-Style Milling Chucks

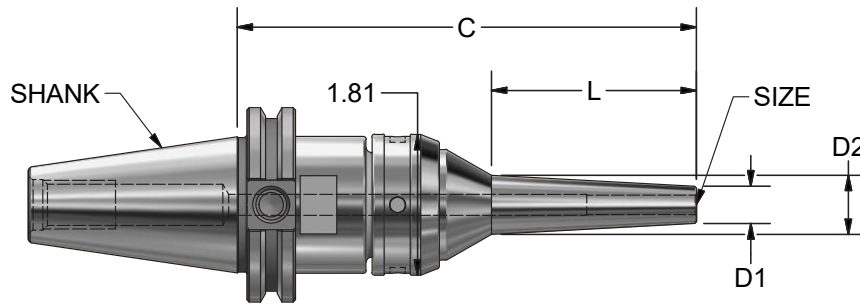

FEATURES

- Officially licensed **BIG-PLUS®** holders
- Simultaneous taper and flange contact with the spindle provides greater rigidity

CAT 40 Mold-Style Milling Chucks with Simulfit

Part #	Old Description	New Description	Bore Size	C	L	D1	D2
74204004	BCV40-HPC0187M-150	CAT40 x MSMC 3/16" - 5.90" Simulfit	3/16"	5.90"	2.63"	.433"	.72"
74204005	BCV40-HPC0250M-150	CAT40 x MSMC 1/4" - 5.90" Simulfit	1/4"	5.90"	2.63"	.48"	.76"
74204006	BCV40-HPC0375M-150-T	CAT40 x MSMC 3/8" - 5.90" Simulfit	3/8"	5.90"	2.63"	.61"	.89"

* BIG-PLUS® is a registered trademark of Daishowa Seiki Kabushiki Kaisha and that Daishowa Seiki Kabushiki Kaisha does not endorse or sponsor the products of Parlec.